

LEGEND

STA. - STA.	BEARING	DISTANCE
AA - AA1	84° 30'	30.00
AA - AA2	175° 16'	30.00
AA - AA3	84° 30'	48.00
AA - AA4	175° 16'	48.00
BB - BB1	284° 44'	12.00
BB - BB2	174° 30'	12.00
BB - BB3	278° 16'	30.14
BB - BB4	243° 17'	31.39
BB - BB5	175° 58'	30.14
CC - CC1	354° 30'	20.00
CC - CC2	284° 43'	20.00
CC - CC3	354° 30'	46.00
CC - CC4	284° 43'	46.00
DD - DD1	19° 11'	14.38
DD - DD2	180° 38'	14.38
DD - DD3	90° 38'	40.38
DD - DD4	112° 39'	40.38
DD - DD5	180° 38'	40.38
EE - EE1	112° 8'	24.32
EE - EE2	144° 33'	25.98
EE - EE3	110° 48'	50.35
EE - EE4	141° 45'	51.82
FF - FF1	278° 29'	45.63
FF - FF2	317° 25'	43.01
FF - FF3	280° 45'	71.03
FF - FF4	318° 0'	69.00
GG - GG1	345° 17'	2.00

LEGEND

STA.-STA.	BEARING	DISTANCE
A-B	150° 59'	7.59
B-C	136° 06'	10.99
C-D	125° 24'	7.79 (7.89)
E-F	89° 45'	3.54
F-G	83° 24'	9.13
G-H	92° 19'	8.74
H-I	175° 28'	12.29
I-J	175° 28'	6.74
J-K	85° 44'	18.59
K-L	99° 32'	10.25
L-M	80° 09'	4.77
M-N	49° 34'	12.16
N-O	25° 47'	6.81
O-P	79° 32'	22.83
P-Q	79° 32'	19.05
Q-R	79° 32'	4.73
R-S	147° 28'	12.81
S-T	163° 40'	6.95
T-U	9° 10'	19.37
U-V	175° 28'	15.83
V-W	175° 28'	6.02
W-X	174° 40'	6.80
X-Y	174° 43'	16.93
Y-Z	118° 03'	12.70

LEGEND

- DISPUTED ZONES: 2.489 Ha. (6.15 Acres)
- SERVICE CENTRE ZONES: 1.0 Ha. (2.47 Acres)
- EXISTING STRUCTURES
- DETENTION PONDS
- GREEN SPACES/ RECREATIONAL: 5.6 Ha. (13.8 Acres)
- BOX DRAINS

GROSS SITE AREA: 6.647 Ha. (164.9 Acres)
 SITE AREA (Excluding Anchor Tenants): 54.592 Ha. (134.9 Acres)

LOT No.	HECTARE	ACRE	LOT No.	HECTARE	ACRE
1	0.21	0.52	40	0.21	0.52
2	0.24	0.59	41	0.21	0.52
3	0.21	0.52	42	0.21	0.52
4	0.21	0.52	43	0.21	0.52
5	0.21	0.52	44	0.21	0.52
6	0.21	0.52	45	0.28	0.69
7	0.21	0.52	46	0.21	0.52
8	0.202	0.50	47	0.21	0.52
9	0.23	0.57	48	0.21	0.52
10	0.22	0.54	49	0.21	0.52
11	0.22	0.54	50	0.28	0.69
12	0.22	0.54	51	0.33	0.82
13	0.22	0.54	52	0.21	0.52
14	0.32	0.79	53	0.24	0.59
15	0.22	0.54	54	0.21	0.52
16	0.21	0.52	55	0.202	0.50
17	0.21	0.52	56	0.21	0.52
18	0.84	2.08	57	0.21	0.52
19	0.86	2.13	58	0.21	0.52
20	0.86	2.13	59	0.85	2.10
21	0.86	2.13	60	0.38	0.94
22	0.86	2.13	61	0.28	0.69
23	0.21	0.52	62	0.24	0.59
24	0.21	0.52	63	0.24	0.59
25	0.25	0.62	64	0.21	0.52
26	0.73	1.80	65	0.25	0.62
27	0.21	0.52	66	0.31	0.77
28	0.21	0.52	67	0.65	1.61
29	0.21	0.52	68	0.207	0.51
30	0.21	0.52	69	0.204	0.504
31	0.40	0.99	70	0.36	0.89
32	0.40	0.99	71	0.26	0.64
33	0.40	0.99	72	0.28	0.69
34	0.40	0.99	73	0.397	0.98
35	0.34	0.84	74	0.21	0.52
36	0.32	0.79	75	0.21	0.52
37	0.21	0.52	76	0.21	0.52
38	0.21	0.52	77	0.36	0.89
39	0.21	0.52			

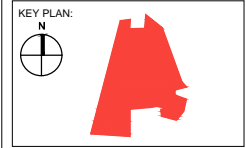

DESIGN-BUILD CONTRACTOR:
 北京建工集团有限责任公司
 BEIJING CONSTRUCTION ENGINEERING GROUP CO., LTD.

PROJECT MANAGER:

NOTES
 1. THIS IS A PRELIMINARY LAYOUT AND IS SUBJECT TO CHANGE BASED ON PLANNING AND STATUTORY REQUIREMENTS. ALL DIMENSIONS AND UTILITY LOCATIONS AND REPORT ALL ERRORS AND OMISSIONS PRIOR TO COMMENCING WORK.

REVISIONS

No.	Description	Date
01	Road extended and vehicular bridge added	28 May 2019
02	WWTTP relocated, lots revised	10 June 2019
03	Disputed area relocated, lot and gross area revised	27 June 2019

DISCLAIMER: THIS DRAWING AND DESIGN IS COPYRIGHT PROTECTED WHICH SHALL NOT BE USED, REPRODUCED OR REVISED WITHOUT WRITTEN PERMISSION BY WSP. THE CONTRACTOR SHALL CHECK AND VERIFY ALL DIMENSIONS AND UTILITY LOCATIONS AND REPORT ALL ERRORS AND OMISSIONS PRIOR TO COMMENCING WORK.
 COPYRIGHT: WSP
 THIS DRAWING IS NOT TO BE SCALED.
 IF THIS BAR IS NOT 25MM LONG, ADJUST YOUR PLOTTING SCALE.
 25MM

PROJECT:
 THE DESIGN AND CONSTRUCTION OF THE PHOENIX PARK INDUSTRIAL ESTATE

PROJECT NUMBER: 185-00018-00 DATE: OCTOBER 2018

TITLE:
 LOTIFICATION PLAN

DESIGNED BY: MJ
 DRAWN BY: CB, R.J.
 CHECKED BY: MJ
 DISCIPLINE: ARCHITECTURE
 DRAWING No.: A- F-003 REV: 03
 SCALE: 1:2500 DATE: 28 JUNE 2019 ISSUE: FOR APPROVALS

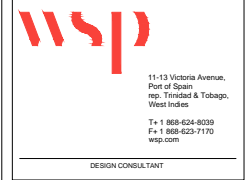

JUNE 2019 - FOR APPROVALS